

New Homes

PRIMA HOMES' STUNNING CUSTOM
IS SET IN STONE FOR ALL TIME

WEBB & BROWN-NEAVES DELIVERS
A SUN-DRENCHED VIBE IN SORRENTO

China doll

REFINEMENT AND HISTORY FIND A VOICE IN
RESIDENTIAL ATTITUDES' DISPLAY IN SUBIACO

  @thewestnewhomes



Build as fine as they come

✦ BY PENELOPE THOMAS

Sleek, industrial and contemporary, the China White display by Residential Attitudes ticks all the right boxes and exudes a tangible sense of history.

Located at the former Australian Fine China factory in Subiaco, Residential Attitudes Senior Designer Michal Kurtis said the display paid homage to its history and boasted an underlying industrial aesthetic.

"Our brief was to achieve a home that displayed a responsiveness to the

precinct," he said.

Innovative and creative, the display explores the designs of urban residential environments and encourages a sense of community through its design.

Expansive stacking doors at the entrance were included to encourage people back to the front of their dwellings and onto the street.

"This will create ample opportunity to interact with neighbours," Mr Kurtis said.

"Depending on the location, this design gives residents the space to enjoy the surrounding vistas."

Mr Kurtis said the front facade with its framed glass elements echoed a factory front. Mixing the raw appeal of the



recycled, the repurposed and the original, the home has an enhanced sense of volume and space that is immediately evident.

The two-storey display uses a mix of articulated forms and materials in its finishes – a salute to the shop fronts that once occupied the site, Mr Kurtis said.

Built on a narrow 8.7 metre-wide lot,

this inner-city urban design has three bedrooms and two bathrooms.

"Efficient use of light and space makes the home feel larger," Mr Kurtis said.

The thoughtfully designed display includes well-zoned spaces that can be used at the

Continued on page 4...





...Continued from page 3.

same time without impacting on those around them.

"There are no wasted or redundant spaces with this design," Mr Kurtis said.

"The communal downstairs living area commands a view to the private internal courtyard and out to the public walkway at the front of the home."

The main living area is a generous and

social space that will bring families together.

"As with all good designs, the kitchen is the hub of the home," Mr Kurtis said.

"It's a place to prepare food, have an informal meal or could be used as a cocktail bar for parties and celebrations."

The bedrooms are located upstairs and occupy two wings of the house, ensuring everyone has their own private space.

"There's enough room for the folks and stay-at-home millennials," Mr Kurtis said.

"The bedrooms all have access to private balcony spaces, which once again provides a greater

sense of space and opulence."

An additional living area on the upper floor looks down to the internal courtyard and main living area.

Although this space is a buffer between the master bedroom and secondary bedrooms, the abundance of natural light makes it feel positive and invites people to sit back, relax and converse.

Designed to bring people together and yet allow everyone their own space, the China White display is a reminder of a slower time when neighbours chatted on the street, and when dashing next door to borrow a cup of sugar was met with a welcome smile.

The display includes well-zoned spaces that can be used at the same time without impacting on those around them.

"The display showcases a different approach to the traditional family home," Mr Kurtis said.

"It's just the right size and is perfect for a growing family who wants to live within a new yet old neighbourhood."

The display is located in Subiaco and is open for viewing Thursdays from 4-7pm and Saturdays and Sundays from 1-4pm.

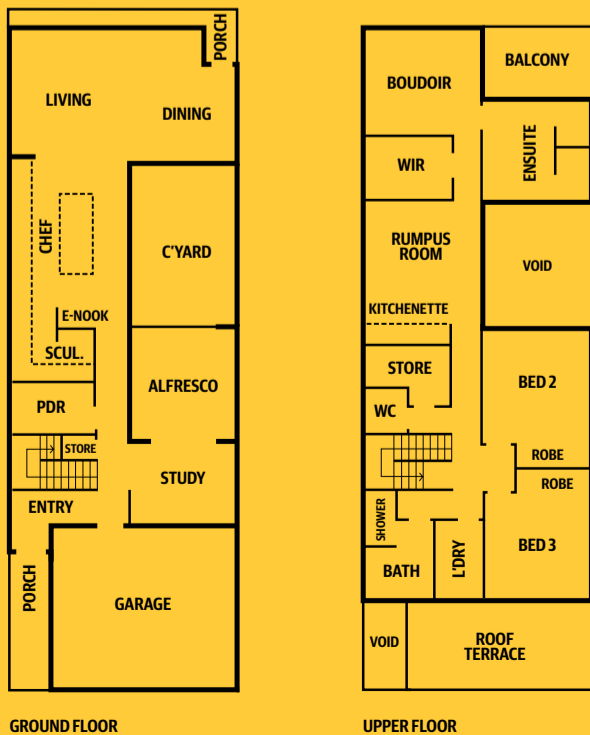

CHINA WHITE

3 2

ADDRESS 10 Carter Lane, Subiaco

PRICE Price on application

BUILDER Residential Attitudes

CONTACT 1800 958 039

www.residentialattitudes.com.au.

